

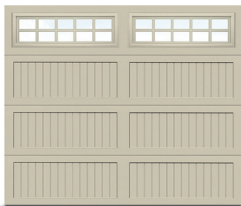

# Aspen™ Series

## Design Choices, Style, Quality

When you are looking for that perfect, new door for your home, look no further than Raynor's Aspen™ Series. With all the design choices Aspen™ offers, you are sure to find the perfect combination that will enhance your home's curb appeal and value.



### AP200

The Aspen™ model AP200 is a 2" thick, thermally efficient door, featuring Neufoam™ polyurethane insulation that fills 100% of the section's interior. Combine this with all the decorative options available, and you have a best-in-class door that just can't be beat.



### AP138

The Aspen™ model AP138 is a 1 3/8" thick door and also features Neufoam™ polyurethane insulation. The AP138 is ideal for moderate climate areas, and offers all of the options available to the AP200.

# AP200 & AP138

## Aspen™ AP200 & AP138

Raynor Aspen™ garage doors are available in two thickness options; 2" and 1 3/8". Both models feature Neufoam™ insulation technology, ensuring that 100% of the section's interior is filled with energy saving polyurethane insulation. Neufoam™ also features the highest foam density in the industry. The 2" thick AP200 has an exceptional R-value of 18, while the 1 3/8" thick AP138 has a R-value of 13. Both doors carry a "For As Long As You Own Your Home" limited section warranty against rust, six (6) year limited warranty on hardware, and a three (3) year limited warranty on springs to the original purchaser.\*

### Aspen™ Panel Construction

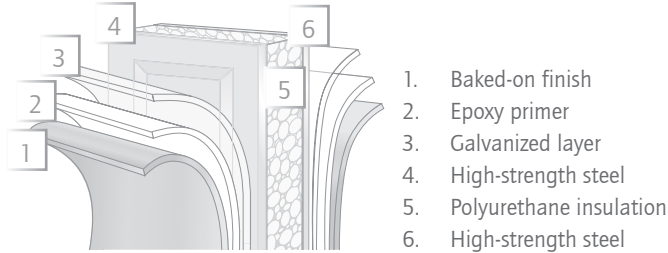

\*See [www.raynor.com](http://www.raynor.com) for complete and full Limited Warranty details.

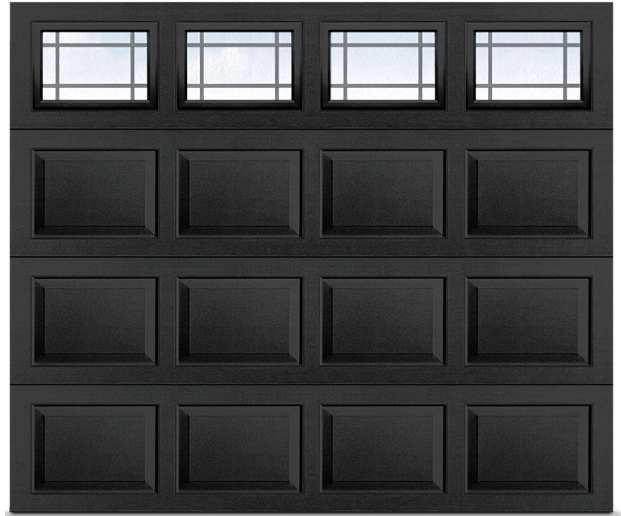

Aspen, black with colonial raised panel embossment and prairie windows.

### Colors

#### Standard



#### Optional Finishes



#### Optional Post Paint Finish



Raynor's OptiFinish™ paint process allows your Aspen door to be customized with more than 1,800 Sherwin-Williams® colors.

\*Black and charcoal colored steel doors come standard with a Cool Chemistry® paint finish to protect from extreme heat. For environments where extreme heat and sunlight exposures are constant, black and charcoal colors are not recommended.

### Hardware Options

#### Standard

Aspen doors feature galvanized steel track and hinges, Egyptian coated springs, and heavy-duty nylon rollers with steel ball bearings for long life and quiet operation.

#### Optional

Raynor's EnduraCote™ system includes white powder coated track, end stiles and hinges, black powder coated extended life springs and torsion bar. The EnduraCote™ option also extends the Limited Warranty\* on hardware and springs to the original purchaser "For As Long As You Own Your Home" against defects in material and workmanship.

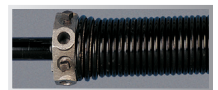

### WeatherLock™ Section Joints

Aspen™ doors incorporate Raynor's exclusive WeatherLock™ section joint. Raynor's proprietary modified tongue-in-groove joint provides exceptional strength, moving the joint forward to increase effectiveness of the air and water seal, keeping out unwanted water and air infiltration, while providing unyielding section strength and integrity.

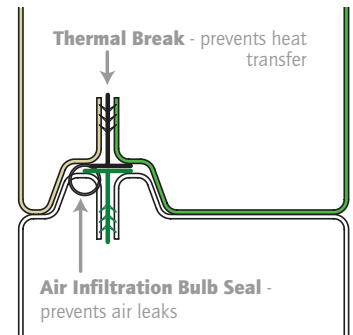

## Panel Options

Aspen™ offers seven distinctly different panel options to help give your home a custom and unique look.



Raised Colonial



Raised Ranch

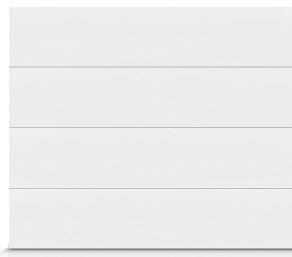

Flush



Mixed Panel  
Raised or Recessed Grooved



Recessed Colonial Grooved

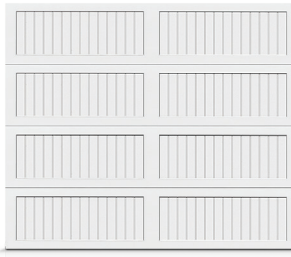

Recessed Ranch Grooved



Plank (Beadline)

### Sizes:

Heights: 6'0", 6'3", 6'6", 6'9", 7'0", 7'3", 7'6", 7'9", 8'0", 8'3", 8'6", 8'9", 9'0", 9'3", 9'6", 9'9", 10'0"

Widths: Most, except mixed panel 4'0" - 20'0" ; mixed panel 8'0" - 20'0"

## Carriage House Panel Spacing Option

### Carriage House Panel Sizes

Carriage House Options are available in:

Width: 8'0" through 20'0"

Height: 6'0", 6'3", 6'6", 6'9", 7'0", 7'3", 7'6", 7'9", 8'0", 8'3", 8'6", 8'9", 9'0", 9'3", 9'6", 9'9", 10'0"

### Standard vs. Carriage House Panels

Capture the look of a carriage house door with specially spaced embossments that replicate the traditional carriage house look of the past and provides additional space between embossments for handles. Available for both raised and grooved recessed panels, both with and without grooves.

Colonial Panels	Size & Spacing	Ranch Panels
	8' Standard	
	8' Carriage House	
	9' Standard	
	9' Carriage House	
	16' Standard	
	16' Carriage House	
	18' Standard	
	18' Carriage House	





# AP200LV LuxeVue

AP200LV LuxeVue door by Raynor® combines all of the aesthetic design options of our Aspen™ Series line with a dramatically larger top window section to create a beautiful door, with stunning curb appeal.

Reference the LuxeVue brochure for more information on the AP200LV.



AP200LV Almond Ranch with Mission Vista Windows



AP200 Almond Ranch with Breckenridge Windows

**Step out of the ordinary** and compliment your home's aesthetic features with a LuxeVue™ door. The AP200LV is the perfect choice for a pristine, high-end, garage door.



## Optional Window & Decorative Hardware

Raynor's many window and decorative hardware options add the finishing touches to your Aspen™ door. These small details customize the door to your home and increase curb appeal.

### Handles



### Magnetic Sets



### Straps



### Misc

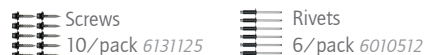

# AP200 VersaView

With Raynor's VersaView door you have the ability to place windows in any location on your door. Create a contemporary look with a vertical row of lights, or get creative in your window placement for a one of a kind look. The VersaView offering increases the amount of light inside your garage while improving the look of your garage door with stylish designs that enhance the curb appeal of your home! Your Raynor Dealer can build you a door with a unique look using the customizable window placement available with the VersaView program for our Aspen AV200 doors.

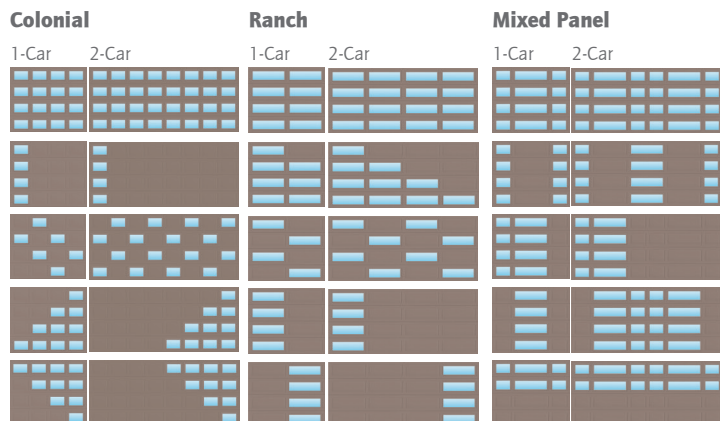

\*VersaView available on 2" Aspen doors only. Tempered glass must be used when placing windows in the bottom 2 sections. Max size of 18' wide x 10' high.

## Window Options



Clear Colonial



Clear Ranch



Sunburst 4



Obscure Colonial



Obscure Ranch



Sunburst 5

### Snap-In Inserts

#### Colonial



Sherwood

#### Ranch



Sunburst Ranch



Sunburst 6



Prairie



Prairie Ranch



Sunburst 7



Cathedral



Arched Stockbridge Ranch



Sunburst 8



Waterton



Waterton Ranch



Sunburst 9



Cascade



Cascade Ranch



Sunray (4 panel)



Stockton



Stockton Ranch



Berkshire



Stockbridge Ranch



Arched Stockton Ranch



Breckenridge

## Openers Convenient and Reliable

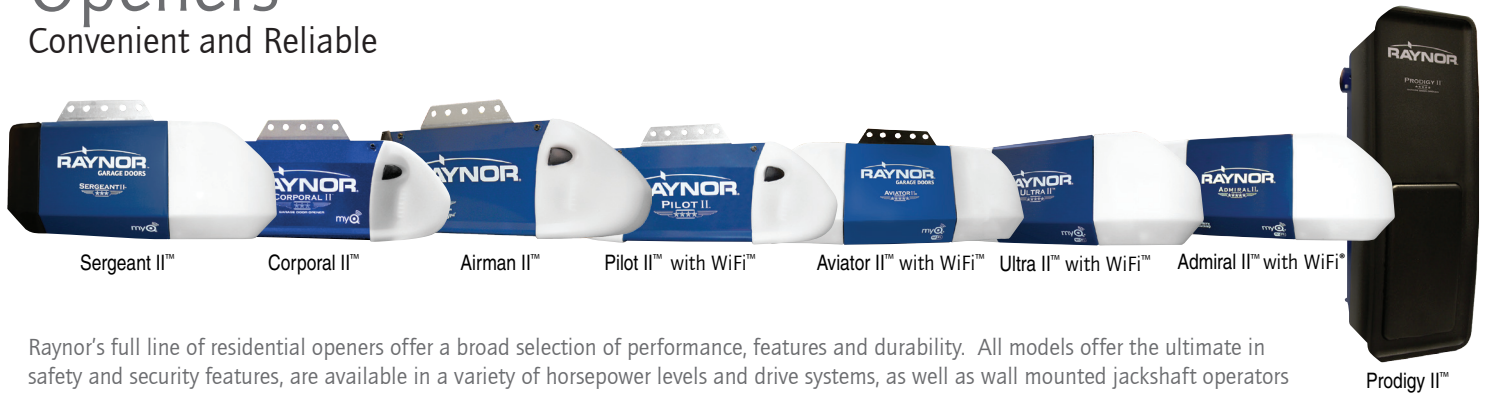

Raynor's full line of residential openers offer a broad selection of performance, features and durability. All models offer the ultimate in safety and security features, are available in a variety of horsepower levels and drive systems, as well as wall mounted jackshaft operators and battery backup systems. MyQ™ technology enables you to securely monitor and control your garage door opener with your smart phone, tablet or computer. Additionally several of our Raynor branded openers now come standard with integrated WiFi.

Raynor's commercial ControlHoist™ operators, with solid-state logic board control, are available in a variety of motor and voltage combinations to meet any commercial or industrial application. Raynor's commercial FireHoist™ fire door operators are UL listed for use with Raynor FireCoil™ doors, as well as for retro-fit applications where existing fire doors require new operators.

For more information on Raynor openers, find the authorized Dealer nearest you at [www.raynor.com](http://www.raynor.com) or call 800-4-RAYNOR (472-9667).

## Follow Us

### Follow Raynor on social media.

Stay in the know with Raynor by following us on social media. Search for Raynor or go direct, below are the links. Want more information? Don't forget to visit our website, [www.raynor.com](http://www.raynor.com).



**Facebook**

<https://www.facebook.com/RaynorGarageDoors/>



**Twitter**

<https://twitter.com/raynordoor>



**YouTube**

<http://www.youtube.com/raynorgaragedoors>



**Pinterest**

<http://www.pinterest.com/raynordoor>



**Houzz**

<http://www.houzz.com/pro/marketing8417/raynor-garage-doors>



P.O. Box 448, 1101 East River Rd.  
Dixon, IL 61021-0448  
1-800-4-RAYNOR (472-9667)

Exclusively Distributed by:

